

STEAM - WATER MIXERS MX20

DESCRIPTION

The steam/water ADCAMix MX20 mixers provide a cheap and instantaneous source of low pressure hot water, by using existing steam and cold water supplies.

The mixer incorporates a safety device, to ensure that live steam cannot be accidentally ejected even if, for some reason, the cold water supply fails.

The temperature of water at the outlet of the ADCAMix is easily controlled by using water and steam valves fitted to the inlets.

MAIN FEATURES

Instant source of low pressure hot water.

Safety device against accidental steam ejection.

Non return valves included.

Complete stainless steel construction.

Quiet operation.

OPTIONS: Alternative steam valve if live steam is required, e.g. for sterilisation.

ACCESSORIES: Stainless steel pedestal.
Adjustable spray gun.
Steam/water inlet valves.
Hot water/steam hose.
Stainless steel suspension for hose.

USE: Saturated steam and cold water.

AVAILABLE MODELS: MX20 – stainless steel.

SIZES: 3/4" x 3/4".

CONNECTIONS: Female threaded ISO 7 Rp.

INSTALLATION: Vertical wall installation.
See IMI – Installation and maintenance instructions.



FLOW RATE CAPACITY – HOT WATER FLOW (L/h)

| STEAM PRESSURE (bar) | HOT WATER OUTLET TEMPERATURE | | | | | | |
|----------------------|------------------------------|-------|-------|-------|-------|-------|-------|
| | 40 °C | 50 °C | 60 °C | 70 °C | 80 °C | 90 °C | 95 °C |
| 2,5 | 1900 | 1400 | 1150 | 900 | 700 | 650 | 600 |
| 3 | 2250 | 1600 | 1230 | 1030 | 900 | 800 | 700 |
| 4 | 2700 | 2000 | 1550 | 1250 | 1000 | 850 | 800 |
| 5 | 3250 | 2300 | 1800 | 1500 | 1250 | 900 | 850 |
| 6 | 3900 | 2900 | 2250 | 1800 | 1500 | 1200 | 1100 |
| 7 | 4200 | 3100 | 2400 | 1950 | 1600 | 1300 | 1200 |
| 8 | 4800 | 3500 | 2700 | 2100 | 1800 | 1550 | 1280 |
| 9 | 5200 | 3900 | 3000 | 2450 | 2000 | 1700 | 1600 |
| 10 | 5900 | 4100 | 3250 | 2700 | 2250 | 1900 | 1750 |

LIMITING CONDITIONS

| | |
|------------------------|---------|
| Minimum steam pressure | 2,5 bar |
| Maximum steam pressure | 10 bar |

Remarks: Steam pressure must be equal to or lower than 3 times the water pressure;
Water pressure cannot be higher than steam pressure.

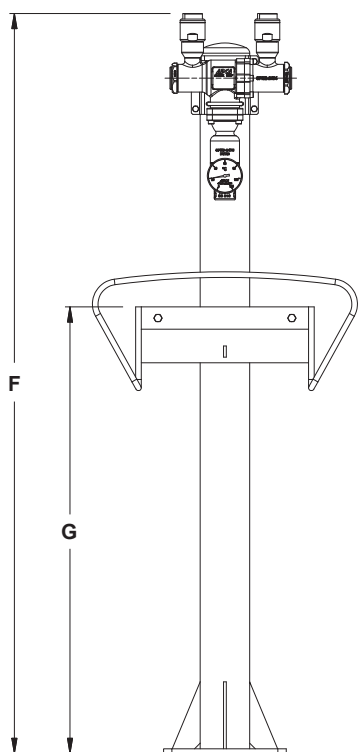
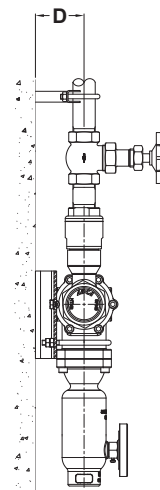
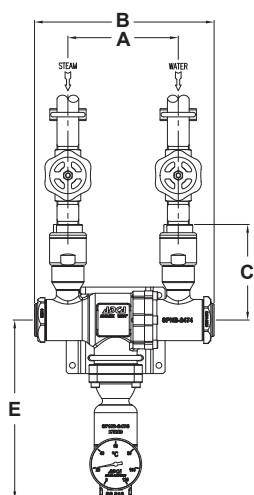

Stainless steel pedestal

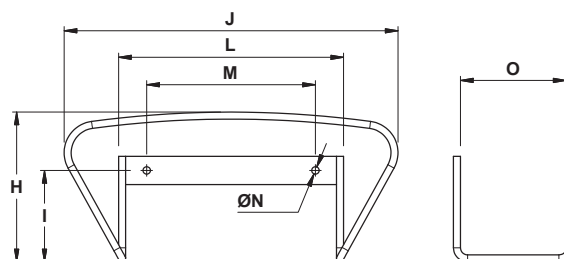

Stainless steel support for hose

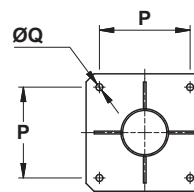

Pedestal base

| DIMENSIONS (mm) | | | | | | | | | | | | | | | | | |
|-----------------|-----|-----|-----|------|-----|------|-----|-----|-----|-----|-----|-----|------|-----|-----|----|-----------|
| SIZE | A | B | C | D | E | F | G | H | I | J | L | M | N | O | P | Q | WGT. (kg) |
| 3/4" | 134 | 220 | 116 | 57,5 | 337 | 1330 | 800 | 213 | 130 | 475 | 320 | 240 | 10,5 | 150 | 170 | 13 | 7 |

MATERIALS

| POS. N° | DESIGNATION | MATERIAL |
|---------|----------------|-----------------------|
| 1 | Steam body | CF8M / 1.4408 |
| 2 | Water body | CF8M / 1.4408 |
| 3 | * Gasket | NBR |
| 4 | Bolts | Stainless steel A2-70 |
| 5 | * Steam valve | St. steel / Graphite |
| 6 | * Valve spring | AISI 302 / 1.4300 |
| 7 | Steam cover | AISI 316 / 1.4401 |
| 8 | * Gasket | PTFE |
| 9 | * Piston | AISI 316 / 1.4401 |
| 10 | Water cover | AISI 316 / 1.4401 |
| 10A | Steam valve | AISI 316 / 1.4401 |
| 10B | * Packing | PTFE |
| 11 | Steam nozzle | AISI 316 / 1.4401 |
| 12 | Mixing chamber | CF8M / 1.4408 |
| 13 | * Gasket | Viton |
| 14 | Support | AISI 304 / 1.4301 |
| 18 | * Check valve | AISI 316 / 1.4401 |
| 19 | * Gasket | PTFE |

* Available spare parts.

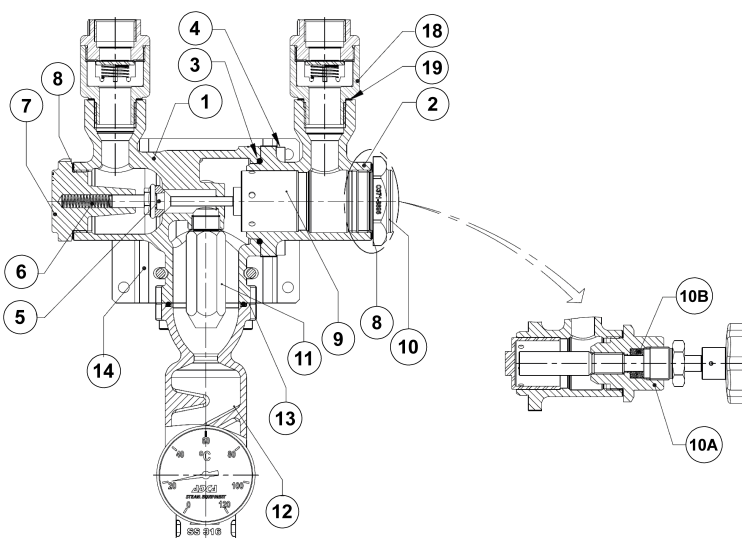

HOSE TECHNICAL SPECIFICATIONS

| | |
|-------------------------|---|
| Tube materials | NBR rubber, clear colour, food quality, odourless, tasteless, smooth, mirror-like. Complies with FDA standards, BfR recommendations and M.D. 21/03/73 and following amendments. |
| Cover materials | NBR rubber, blue colour, abrasion, ozone and weather resistant, smooth, cloth finish. |
| Reinforcement materials | Heat resistant synthetic textile plies. |
| Temperature range | From -20 °C to 95 °C. Up to 164 °C for saturated steam cleaning operations (short peaks) – limited to a working pressure of 6 bar. Sterilisation up to 130 °C for a maximum time of 30 minutes. |
| Inner diameter | 19 mm. |
| Outer diameter | 31 mm. |
| Wall thickness | 6 mm. |
| Burst pressure | 60 bar. |
| Approx. weight | 0,58 kg/m. |